

PRIDE IN OUR COMMUNITY

Westminster Terrace Assisted Living Community opened in 2001 and is proud to continue the tradition of providing quality care to seniors in Orange County. We are proud of our long term staff members, some of whom have been committed to caring for our community residents for several years.

Nestled back away from the hustle and bustle of the City of Westminster, our beautiful community invites seniors in to enjoy our services and our amenities. Our grounds are complemented by shady walkways, the sound of trickling water in our courtyard fountain, and the accents of flora in the landscape. From benches and patio chairs, residents rest, relax and socialize.



Life at Westminster Terrace offers freedom from household chores and dining with choices from an extensive menu of freshly cooked meals. Our activity program provides opportunities to enjoy a calendar of comprehensive activities designed with individual interests in mind. Choices to meet physical, educational, spiritual and social needs are available for our residents. Our close proximity to Westminster Mall, Bella Terra, Shoreline Village, and our beautiful California beaches, offers many opportunities for outings year-round.

Enhancing our amenities is a staff that understands the importance of each individual's needs for assistance. We work closely with our local medical professionals and their teams. Of convenience is our location between four major hospitals and many other health care providers. We strive to embrace individual care needs with supportive services and exceptional care.

Come share in the lifestyle we have to offer. Choose Westminster Terrace. We're here for you.

Westminster Terrace 7571 Westminster Avenue Westminster, CA 92683 (714) 891-6608 WestminsterTerrace.com
Lic # 306001421

RESPIRE CARE

Respite Care & Vacation Care & Senior Guest Stay

Our **Respite Program** may just provide you with what seniors and their families need – time to relax, recuperate and rejuvenate. We offer stays of a few days up to a month with our full range of services and amenities for our guests. Families and caregivers can enjoy their time with the comfort of knowing that their loved one is cared for in a comfortable, yet active setting.

Our **Vacation Care Program** gives families and caregivers opportunity for that precious vacation time. We offer refreshing options for their loved ones to also enjoy time meeting new friends and socializing while receiving attention to their personal care needs.

Our **Senior Guest Stay Program** offers seniors a short term option with us to sample our levels of service, taste our home-style chef-prepared meals, experience our activities, and enjoy our community atmosphere before making a new beginning here at Westminster Terrace. Our staff looks forward to meeting and providing service to our residents and guests alike.

Respite Services \$140 per day

For more information on our rates and services, please contact us or stop by for a tour. It is our pleasure to have you as a guest for lunch or dinner. We look forward to meeting you!



RATES AND SERVICES

Westminster Terrace is a warm, home-like community that strives to meet the needs of our residents and encourages activity and independence. We encourage our residents to decorate their apartments with favorite things such as furniture, family photos, special heirlooms - even pets are welcome. Choose from a studio or one bedroom apartment and enjoy the convenience of a kitchenette or patio.

Monthly Base Rates

Companion	starting at \$1,300 monthly
Studio Apartments.....	starting at \$2,000 monthly
Deluxe Studio Apartments	starting at \$2,650 monthly
One Bedroom Suites	starting at \$3,350 monthly
Second Person Fee	\$800 monthly
New Resident Fee	\$1,200 (one time only)

Assisted Living Services

As personal needs arise, we offer our residents additional services to provide the assistance they need and desire. Our care team provides an individually tailored service plan to meet and support our residents' independence. Fees vary depending on support services needed.

Care Costs	starting at \$350 monthly
------------------	---------------------------



Respite Services

We offer stays of a few days up to a month with our full range of services and amenities for our guests. Families and caregivers can enjoy their time with the comfort of knowing that their loved one is cared for in a comfortable, yet active setting.

Respite Services.....	\$140 per day
-----------------------	---------------

FEATURES & AMENITIES & SERVICES

At Westminster Terrace we offer a variety of amenities and services. Our goal is to support individual independence while providing opportunities to continue to live life! We offer freedom from the stress of household chores, giving choices for ease of comfort in daily living.

Everyday Living

- ✦ Choose from a variety of apartment styles
- ✦ Each apartment includes individually controlled heating and air conditioning, emergency call system, fire sprinkler system, smoke and fire alarms
- ✦ Relax in our beautiful, serene courtyard
- ✦ We offer basic utilities and cable (except telephone)
- ✦ Apartments are internet capable
- ✦ Small pets are welcome

Dining With Relaxation

- ✦ Taste chef-prepared meals daily from a menu of delicious choices
- ✦ Indulge your fancy in delightful conversation in our dining room
- ✦ Entertain your guests in our private dining room, main dining or patio areas

Active Living/Transportation

- ✦ Choose from a comprehensive calendar of events, outings and activities
- ✦ Visit Westminster Terrace's Beauty Salon and Barber Shop
- ✦ Select from manicure services
- ✦ Enjoy scheduled entertainers and speakers
- ✦ Use our transportation to your medical appointments or shopping

Personal Support Options

- ✦ Wellness program overseen by Licensed Nurse
- ✦ Our trained and caring staff available 24 hours a day
- ✦ Choose assistance services such as bathing, dressing, grooming, medication management, or other activities of daily living



It is our pleasure to provide further detail regarding our many services.

APARTMENTS

The Parkview

One Bedroom, One Bath

530 Square Feet

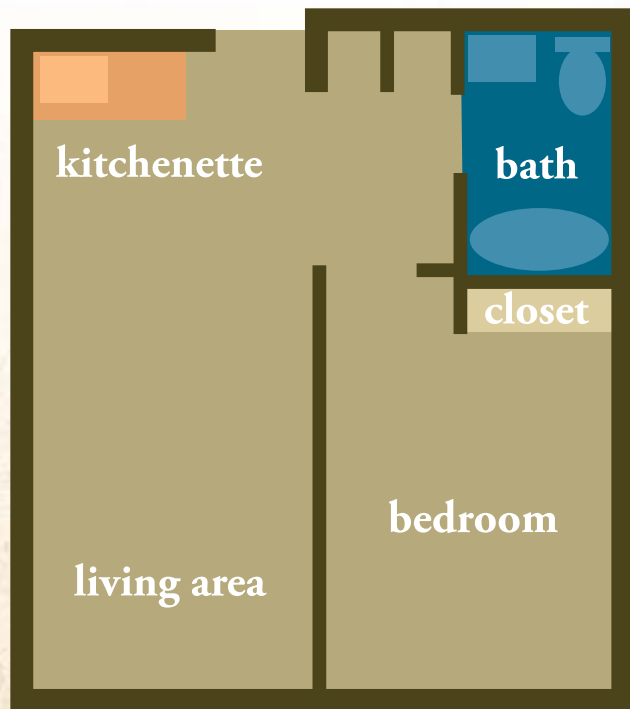

The Fountain Studio

352 Square Feet

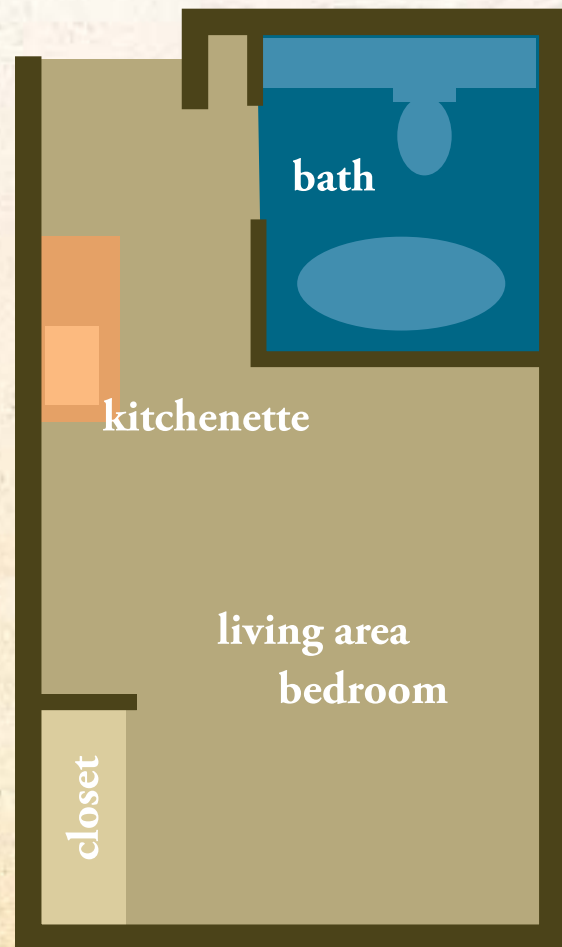

APARTMENTS

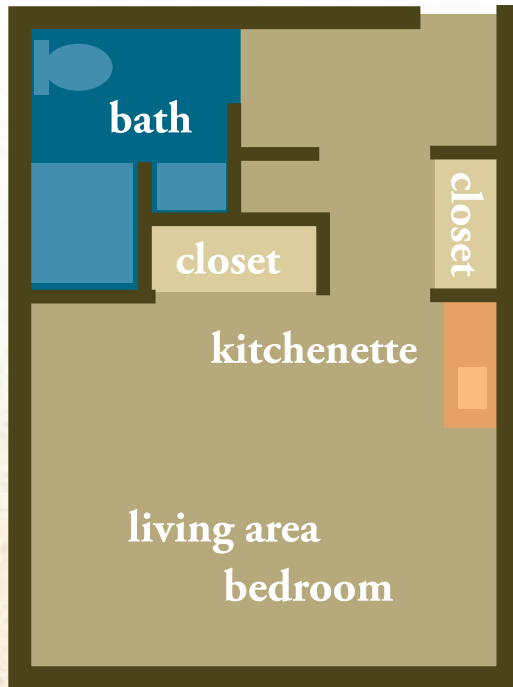

*The Ivy
Studio*
408 Square Feet

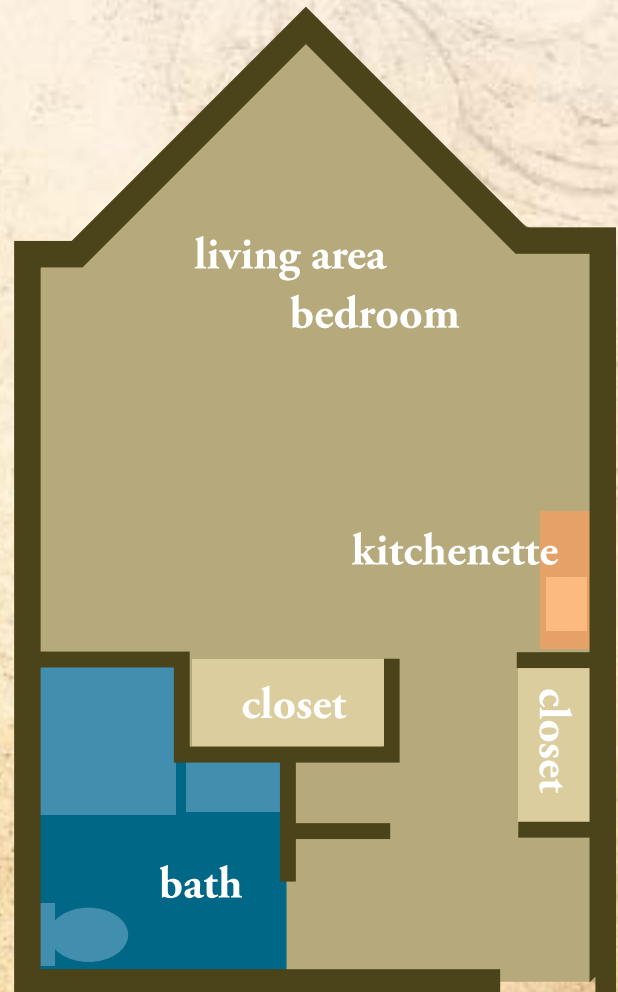

*The Garden
Studio*
440 Square Feet